

Aftertreatment Shut-off Valve  
Replacement  
D13F

## Aftertreatment Shut-off Valve, Replacement

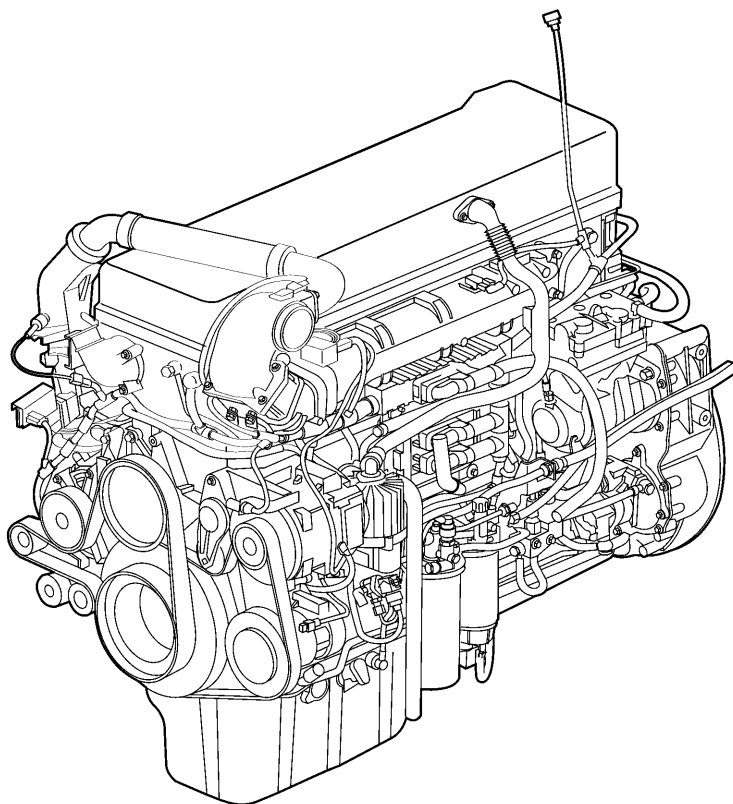

W2005941

This information covers replacement of the aftertreatment shut-off valve used with the DPF system on a Volvo D13F engine.

### Contents

- “Shut-off Valve, Aftertreatment, Replacement” page 2

**Note:** Information is subject to change without notice.  
Illustrations are used for reference only, and may differ slightly from the actual engine version. However, key components addressed in this information are represented as accurately as possible.

# Service Procedures

## 2589-03-02-15

### Shut-off Valve, Aftertreatment, Replacement

See also:

- "Aftertreatment Shut-off Valve, Replacement" page 1

You must read and understand the precautions and guidelines in Service Information, group 20, "General Safety Practices, Engine" before performing this procedure. If you are not properly trained and certified in this procedure, ask your supervisor for training before you perform it.

## Removal

- 1**  
Apply the parking brake and place the shift lever in neutral.
- 2**  
Remove all cables from ground (negative) battery terminals to prevent personal injury from electrical shock.
- 3**  
Disconnect both electrical connectors from the top of the aftertreatment shut-off valve, located on the left side of the engine to the rear of the fuel filters.

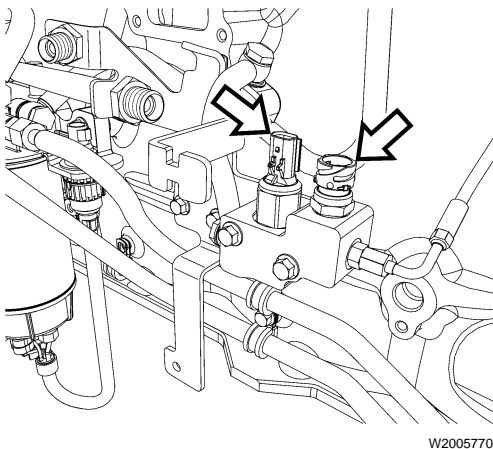
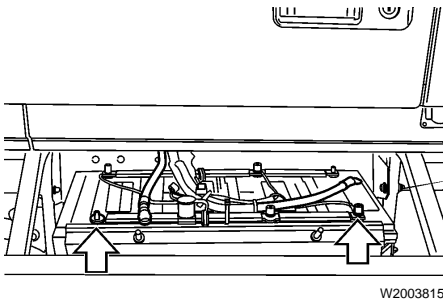

- 4**  
Remove the clamp bracket screw from the fuel pump lines and reposition lines out of the way.

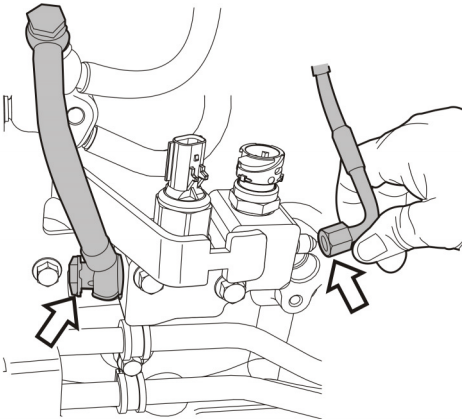

W2005769

**5**

Disconnect both inlet and outlet fuel hose connection from the aftertreatment shut-off valve. Collect any residual fuel that may flow from the fuel lines in a suitable container.

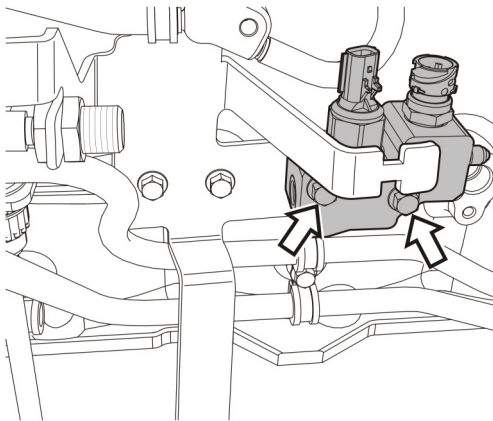

W2005768

**6**

Remove the bolts securing the shut-off valve to the left side of the engine block and remove the valve.

## Installation

**1**

Position the shut-off valve assembly on the block pads and install the bolts. Torque-tighten the bolts to specification.

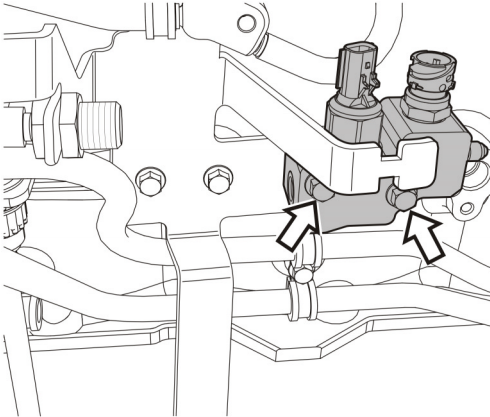

W2005768

**2**

Reconnect the inlet fuel hose connection to the aftertreatment shut-off valve and install with two new sealing washers. Also, reconnect the outlet hose to the fitting on the valve. Tighten all fittings securely.

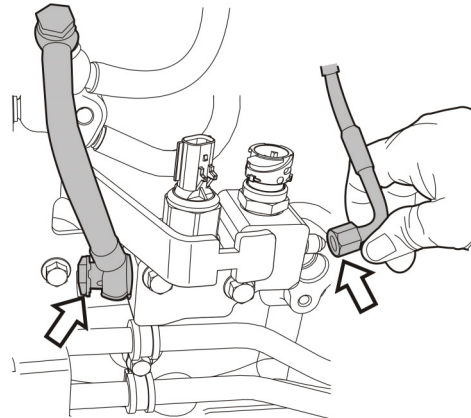

W2005769

**3**

Reconnect the fuel pressure sensor and electrical connectors to the top of the aftertreatment shut-off valve.

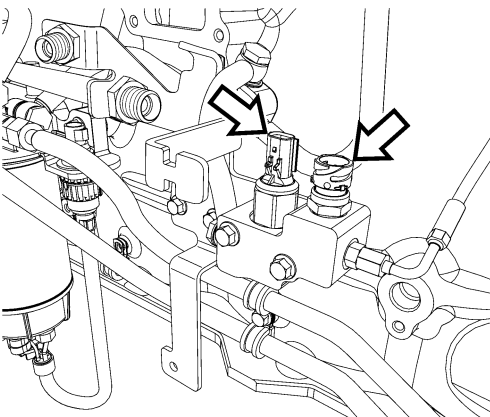

W2005770

**4**

Place the previously moved fuel lines in position against the cylinder block and install the clamp bracket and screw.

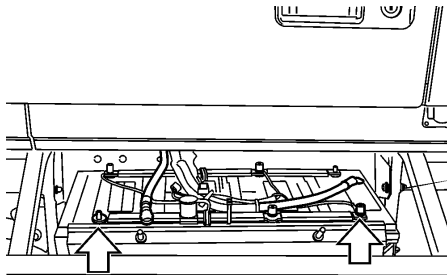

W2003815

**5**

Install all previously removed cables to the ground (negative) battery terminals.

**6**

Start the engine, check for leaks and proper operation. After shutdown, replenish fluids as necessary.