

Pump Module (L074)

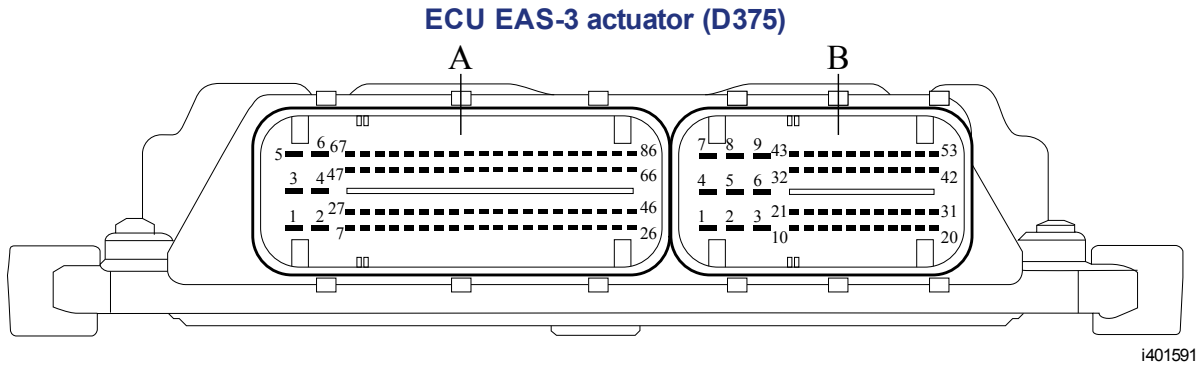

A	Electronic unit connection point				
B	Description of connection point				
C	Reading at connection point (Ubat = battery voltage)				
D	Measuring unit				
E	Explanatory notes (if applicable)				
F	The 'X' indicates that additional information is available in 'Technical Data.'				
A	B	C	D	E	F
A03	Signal, DEF heater	<0.5	VDC	When heater or defrosting is activated	X
A05	Supply, DEF heater	Ubat	VDC	Contact switched on	X
A17	Signal, DEF pressure sensor	0.5–4.5	VDC	Voltage depending on the measured pressure	
A18	Ground, DEF pressure sensor	<0.5	VDC		
A19	Supply, DEF pressure sensor	±5	VDC	Open voltage, with detached connector. Contact switched on.	
A24	Signal, DEF pump motor PWM/pump module		%	At key on, the wiring is used to transmit	

	temperature			temperature information from the supply module to the EAS-3 actuator.  Once defrost heating is finished or it is determined it is not needed, this wire is reversed so that the EAS-3 actuator can use it to drive the motor.	
A26	Ground, DEF pump motor	<0.5	VDC		
A46	Supply, DEF pump motor	Ubat	VDC	Contact switched on	
A65	Signal, reverting valve	<0.5	VDC	When the reverting valve is energized, this pin is switched to ground. The reverting valve is energized during purge.	
A86	Supply, reverting valve	Ubat	VDC	Contact is switched on.	

Pump module

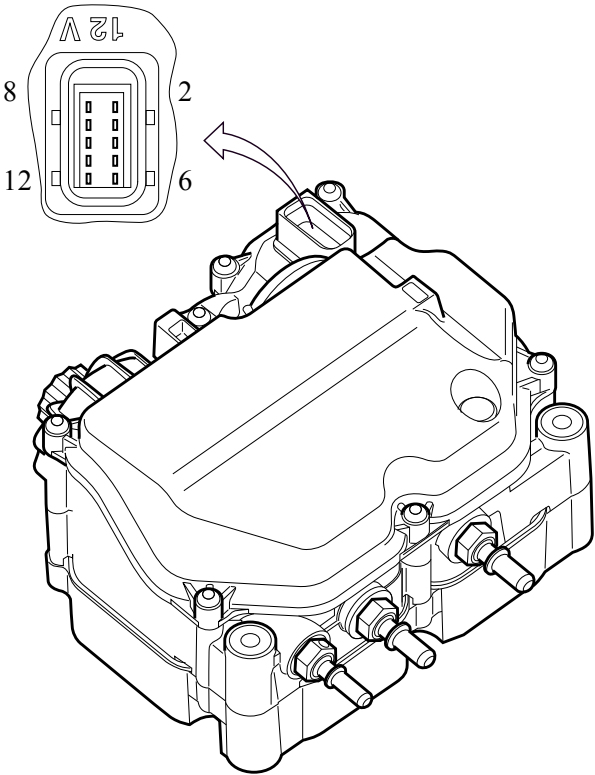

Electrical connections, pump module

- 1 -
- 2 Supply, DEF pressure sensor
- 3 Signal, DEF pressure sensor
- 4 Ground, DEF pressure sensor
- 5 Supply, DEF heater
- 6 Signal, DEF heater
- 7 -
- 8 Ground, DEF pump motor
- 9 Supply, DEF pump motor
- 10 Signal, DEF pump motor PWM/pump module temperature
- 11 Supply, reverting valve
- 12 Signal, reverting valve

Check Valve

Opening pressure check valve 1.45 psi (0.1 bar)

Defrost heating (internal heaters)

On below 25°F (-4°C)  
Off above 25°F (-4°C)  
Duty cycle 99%

Maintenance heating (internal heaters)

On below 41°F (5°C)  
Off above 50°F (10°C)  
Duty cycle see following table

Ambient temperature (°F)	-22 (-30°C)	-4 (-20°C)	14 (-10°C)	32 (0°)	41 (5°C)	50 (10°C)
Duty cycle (%)	50	40	30	20	10	10

M026990 - 08.12.2010

This information applies exclusively to the entered chassis number or the selected engine type. Please take into account that this information may change daily. Therefore the provided information is only valid on 12-19-2015. You cannot derive any rights from the information provided with respect to vehicles and/or components of another series, with another chassis number, and/or of another date. ( / )