

Valve, air shutoff (L071)

The air shutoff valve is used to purge the system of diesel fuel after regeneration. This way, no fuel is close to the hot exhaust during nonregeneration conditions. When regeneration is complete, the air shutoff valve is opened and air supply is admitted into the fuel intake module. The fuel-dosing module is opened and the diesel in these components is purged into the exhaust gas flow.

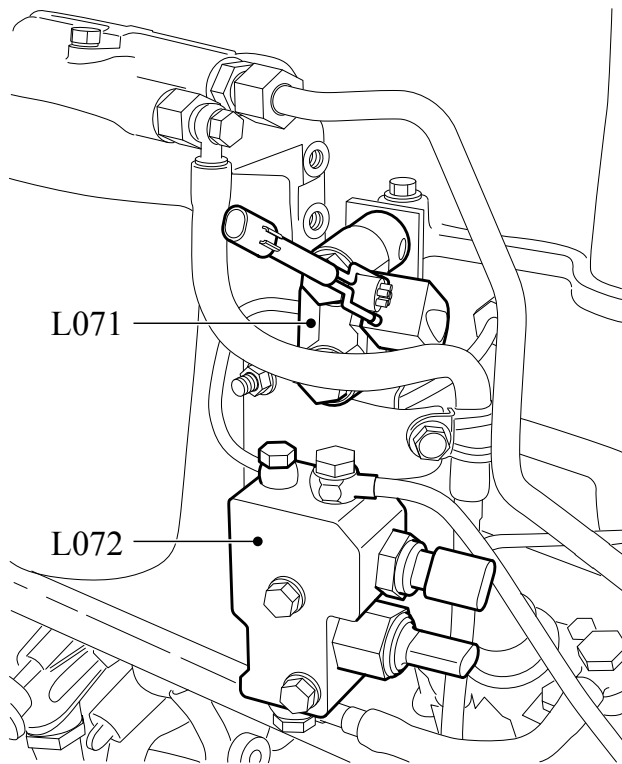

i401687

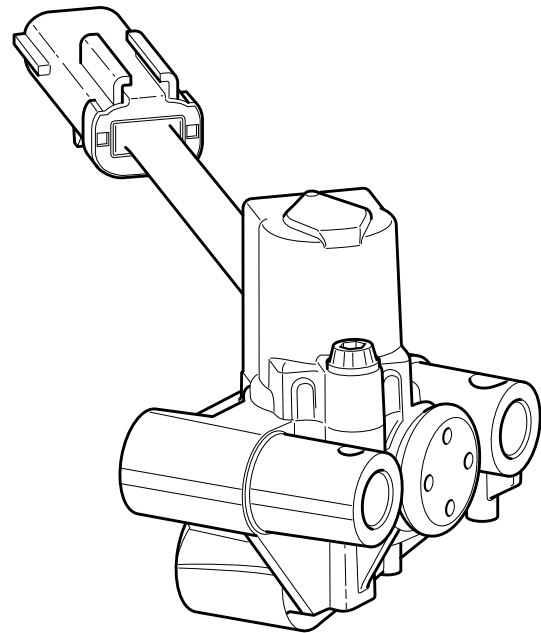

i401689

M027006 - 02.23.2010

This information applies exclusively to the entered chassis number or the selected engine type. Please take into account that this information may change daily. Therefore the provided information is only valid on 12-19-2015. You cannot derive any rights from the information provided with respect to vehicles and/or components of another series, with another chassis number, and/or of another date. (/)