

## Back-Pressure Valve

The Back-Pressure Valve (BPV) is a butterfly valve. The BPV (1) is operated via an air operating cylinder (2). When the actuator BPV receives an electrical signal from the PMCI-2 unit, a solenoid valve opens the air connection. When this air connection is open, air can flow from the vehicle air supply to the operating cylinder. The operating cylinder closes the BPV. There is a position feedback to the PMCI-2 unit via the position sensor (3) mounted on the cylinder. When the BPV is closed, there is a higher back pressure build-up in the exhaust manifold.

The Back Pressure Valve is used for:

- Stationary regeneration (After treatment)
- Mobile regeneration (After treatment)

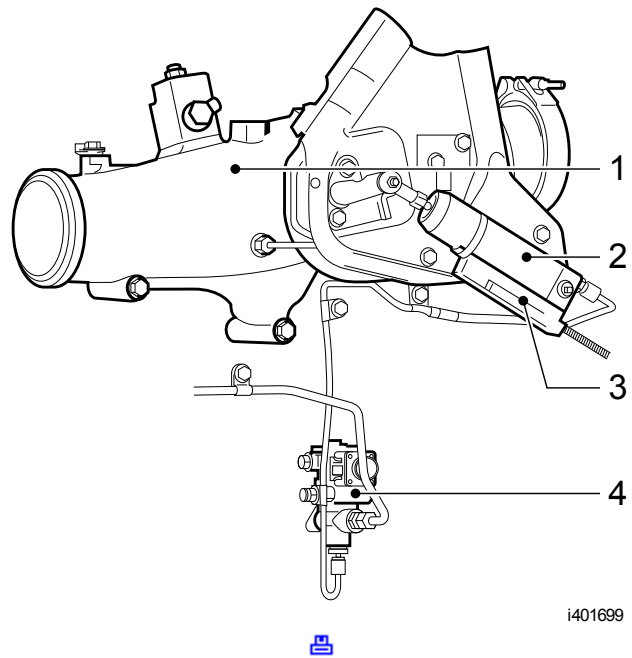

- 1 Back-pressure valve (BPV)
- 2 Operating cylinder
- 3 BPV position sensor (F811)
- 4 BPV actuator (L020)

M028451 - 02.19.2010

This information applies exclusively to the entered chassis number or the selected engine type. Please take into account that this information may change daily. Therefore the provided information is only valid on 12-12-2015. You cannot derive any rights from the information provided with respect to vehicles and/or components of another series, with another chassis number, and/or of another date. ( / )