

DETAIL A

**OBSOLETE**  
SUPERSEDED BY 95-1033

PROD	X
SERV	X

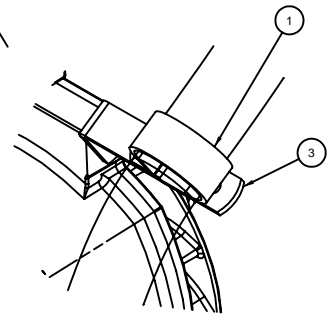

DETAIL B

MOUNT UNDER UPPER RH BOLT OF ALTERNATOR.  
ORIENT AS REQD. FOR CONSISTENT ROUTING.

- GENERAL NOTES:
- 1) USE WITH ALL B CABS EXCEPT T600, T8W, V9S, AND C5W, T800 IS SHOWN.
  - 2) SEE: R414-1078 FOR 1200 RADIATOR  
R414-1098 FOR 1430 RADIATOR

1	4	K077-123-8	CLAMP-CUSHION	
1	3	K028-867	ANCHOR-THROTTLE SPRING	
2	2	K077-123-40	CLAMP-CUSHION	
2	1	JM56LC1SY24NT	CLAMP-CUSHION	
QTY	ITEM	PART NUMBER	PRODUCT DESCRIPTION	MATERIAL