

Sealing the Lower Pinion Cover, Model 4 Freightliner Rear Axles

35-25

FLA COE
FLB COE
> FLD Conventional
Business Class
FLC 112 Conventional

> Century Class Conventional
> Argosy COE
Cargo
> Columbia

> Coronado
> Business Class M2
> Cascadia
> 108SD/114SD

**Freightliner
Service Bulletin**

General Information

Model 4 Freightliner rear axles have a lower pinion cover that may need to be removed to inspect for damage or to reseal it to prevent water intrusion. When installing the lower pinion cover, seal it per the following instructions.

Sealing the Lower Pinion Cover

1. Clean the bond surfaces of the cover and housing. Use a putty knife to remove any residual sealant.
2. Apply Loctite 5900® sealant to the bond surface of the *carrier housing* as shown in **Fig. 1**. Do not apply sealant to the cover.
3. Install the lower pinion cover. Tighten the capscrews 65 lbf-ft (85 N·m).
4. Apply Loctite 5900 to the area at the top of the cover as shown in **Fig. 2**. This seal prevents water from collecting and seeping behind the cover and into the housing.

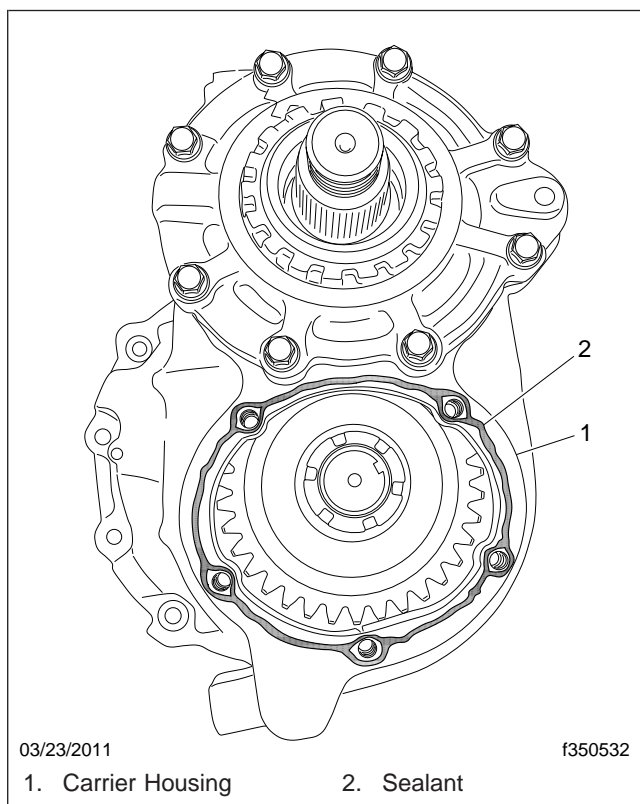

Fig. 1, Sealant Applied to Carrier Housing

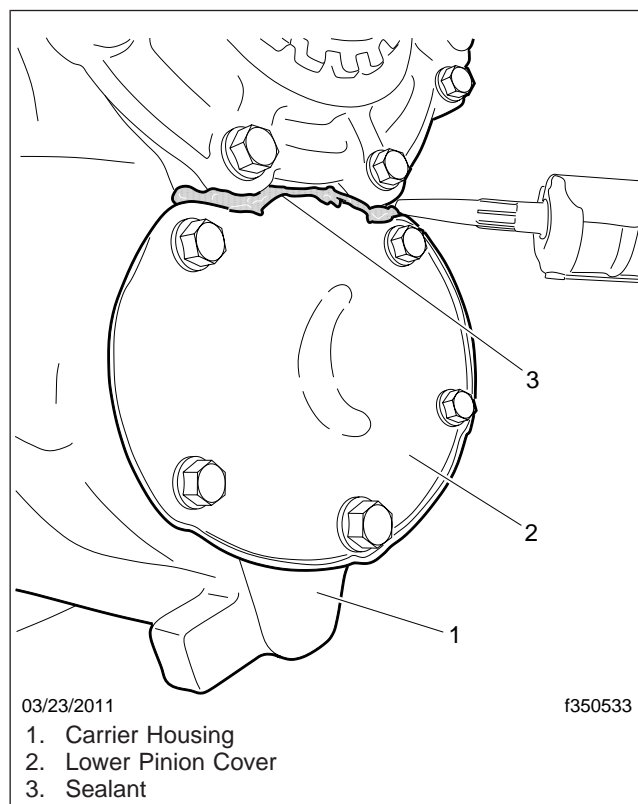

Fig. 2, Sealing the Top of the Lower Pinion Cover

Warranty

This procedure is warrantable only if a warrantable failure exists and the repair is performed within the applicable base or extended coverage warranty period. If a failure is not found, this procedure is considered preventive and warranty does not apply.

Freightliner
Service Bulletin

FLA COE
FLB COE
> FLD Conventional
Business Class
FLC 112 Conventional

> Century Class Conventional
> Argosy COE
Cargo
> Columbia

> Coronado
> Business Class M2
> Cascadia
> 108SD/114SD

Normal warranty applies. See [Table 1](#) for QuickClaim damage code and labor allowance information. Refer to this service bulletin by number at the beginning of the claim comments.

See [Table 2](#) for OWL VMRS codes and labor allowance information. Enter this service bulletin number in the *Service Bulletin #*: field.

QuickClaim Damage Code and Labor Allowance			
Damage Code	SRT Code	Description	Time: Hours
420-100086609	420-0105B	Cover, Axle Alliance - Front Lower, Replace or Reseal	0.3

Table 1, QuickClaim Damage Code and Labor Allowance

OWL VMRS Codes and Labor Allowance				
Component Code	Cause Code	SRT Code	Description	Time: Hours
022-003-014	18	420-6105B	Cover, Axle Alliance - Front Lower, Replace or Reseal	0.3

Table 2, OWL VMRS Codes and Labor Allowance