

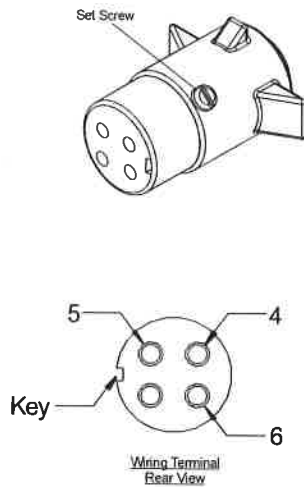

4. Use a plug and socket when the vehicle is a refrigerated body. Remove the set screw to access the wire terminals. **Never store remote inside refrigerated vehicles, control will be damaged.**



Plug
Plug to Control Wiring Table

Function	Plug	Remote
Up	5	5.2 / Red
Down	6	6.2 / Yellow
12V (Hot)	4	4.3 / Green

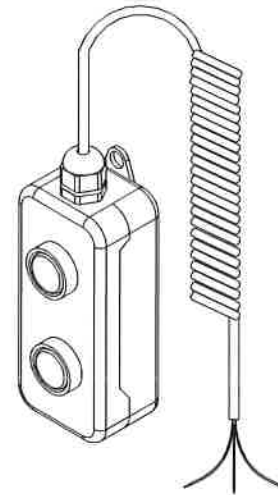

Hand Held Remote

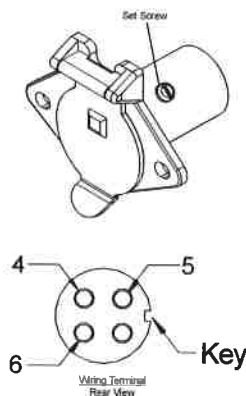

Socket
Socket to Pump/Motor

Function	Socket	Pump Motor
Up	5	Solenoid
Down	6	Release Valve
12V (Hot)	4	On/Off Switch

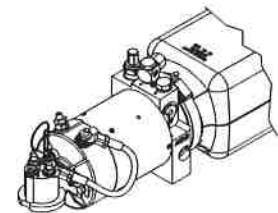

Hydraulic Power Unit

5. Reference Sections 13.9-13.10 for wiring diagram.

13.9 Electrical Schematic (Gravity Down)

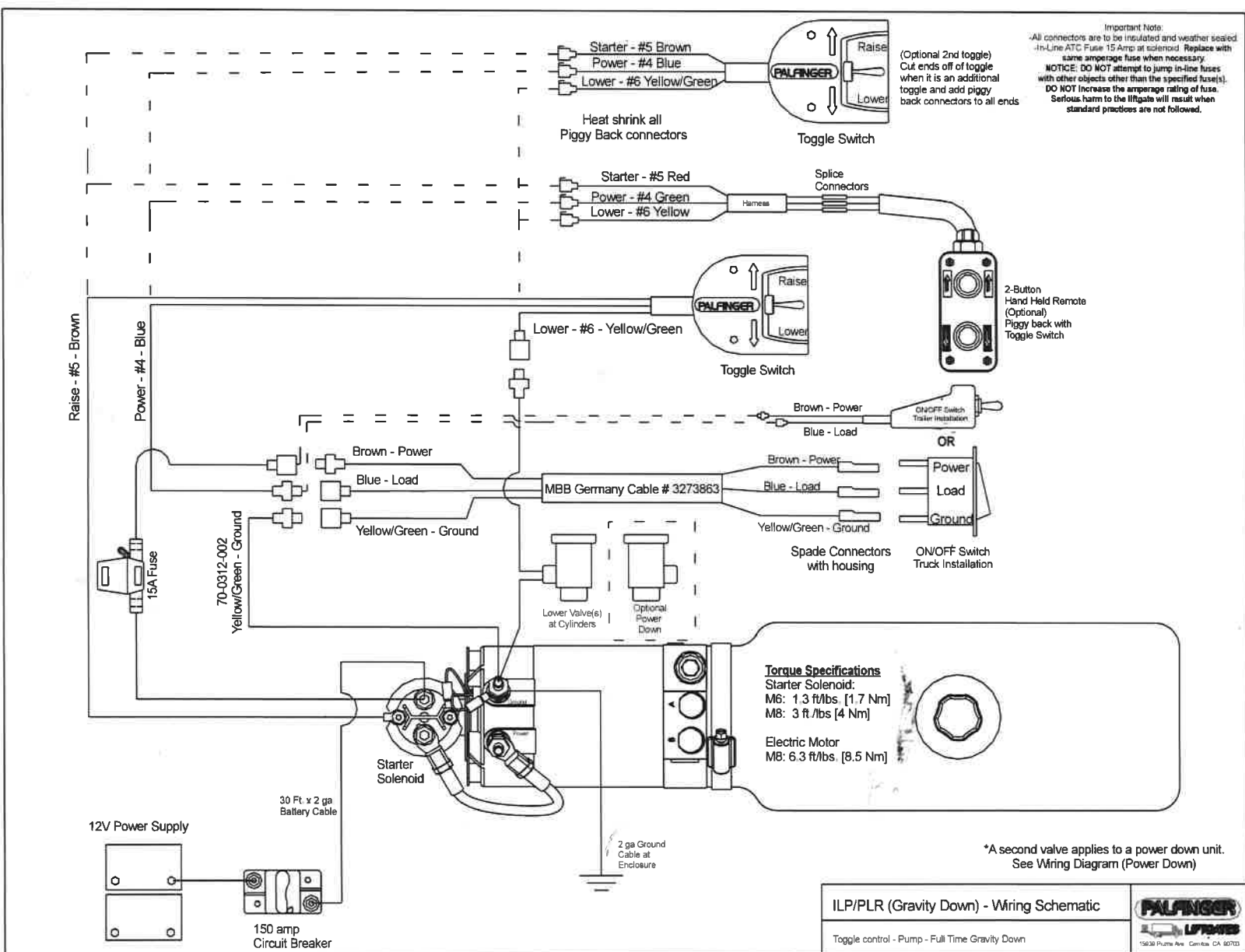

13.10 Electrical Schematic (Power Down)

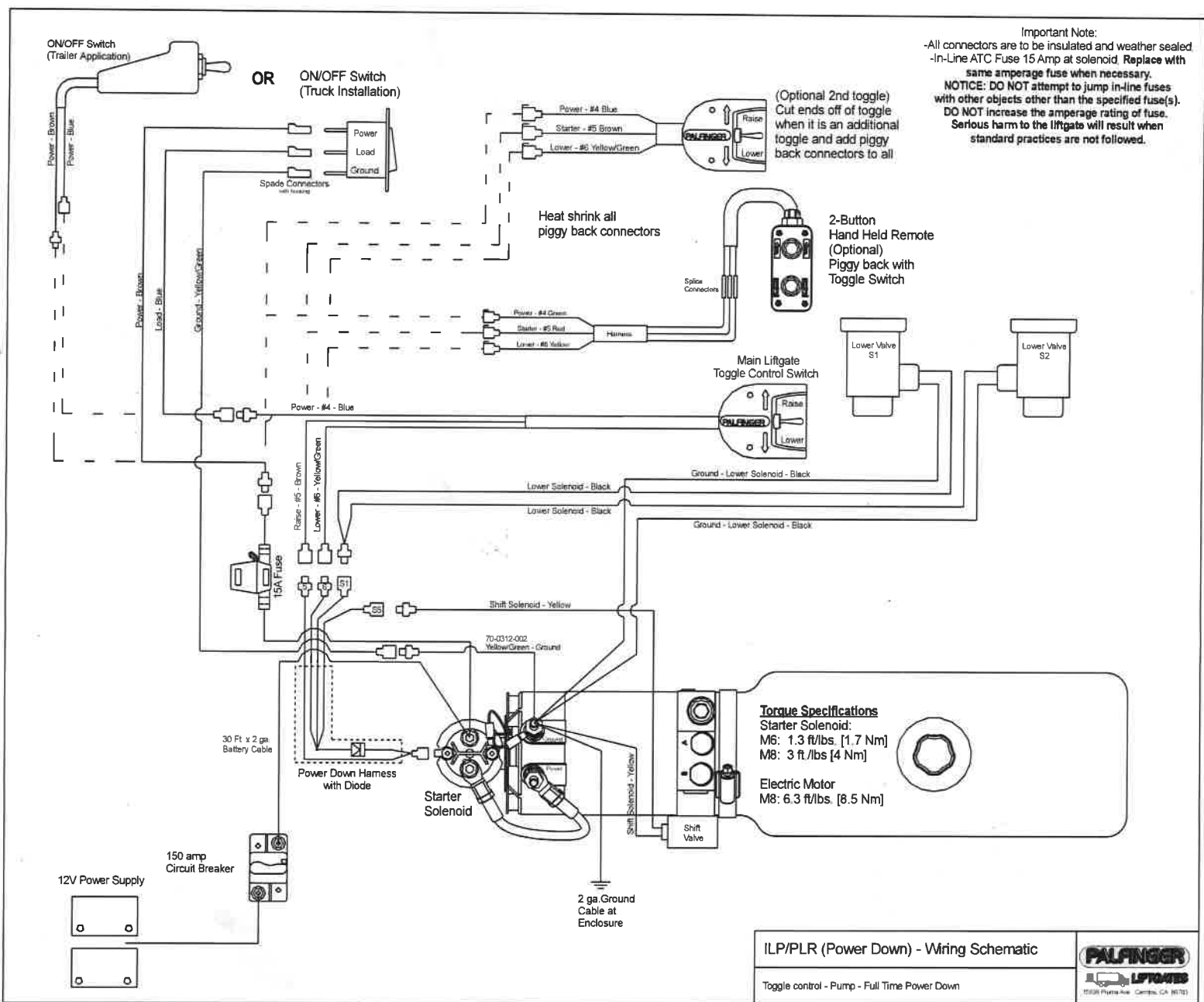

14 Hydraulic Schematic (Gravity Down)

NOTICE

- Insure that all hydraulic hoses are secured and away from heat sources, sharp corners/edges, and abrasion from moving components during the operation of the liftgate and vehicle.

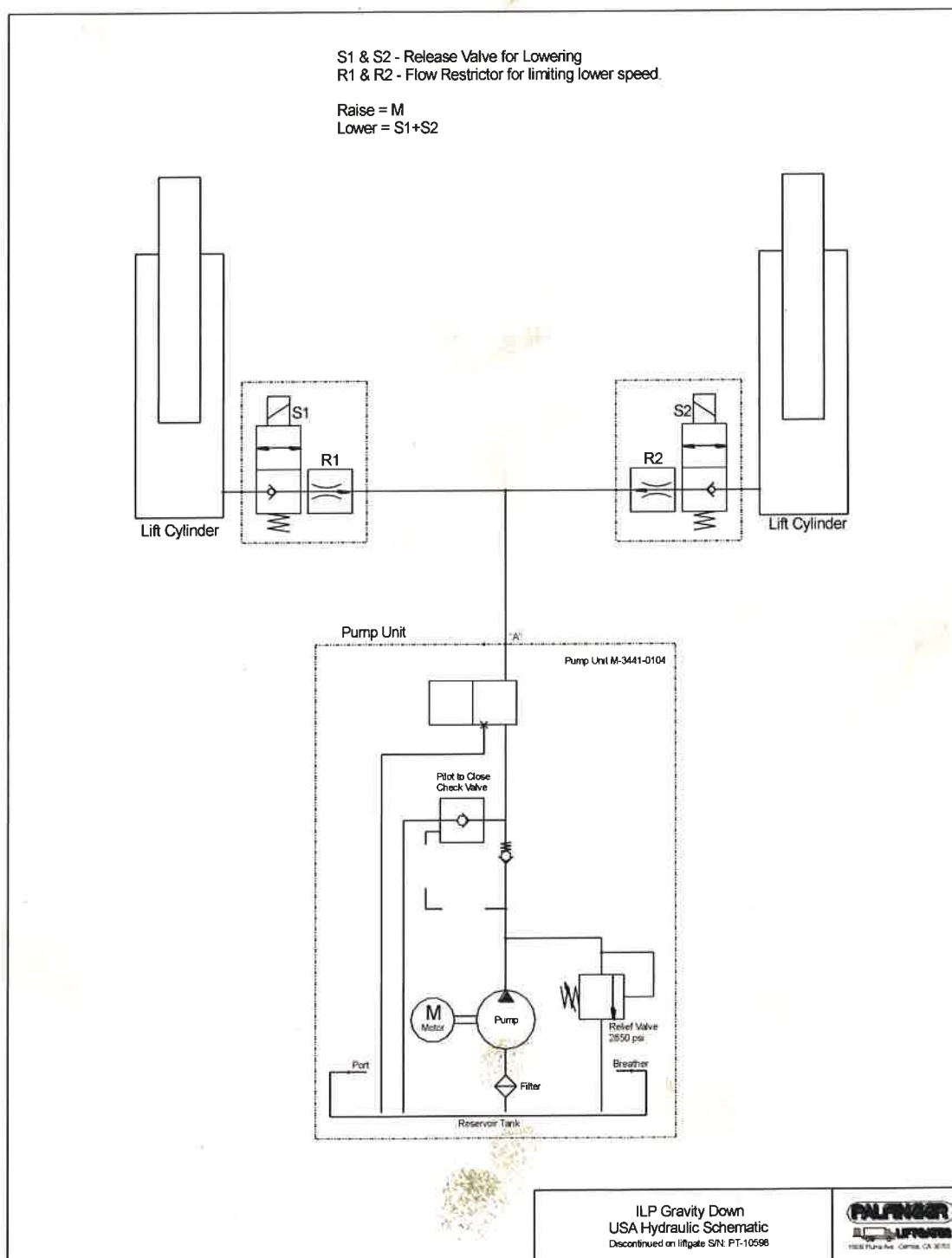

14.1 Hydraulic Schematic (Power Down)

S1 & S2 - Release Valve for Lowering
 R1 & R2 - Flow Restrictor for limiting lower speed.
 S5 - Shift Valve is activated upon LOWER function only.
 Pilot to close check valve is NOT used on Power Down.

Raise = M

Power Down = M + S1&2 + S5

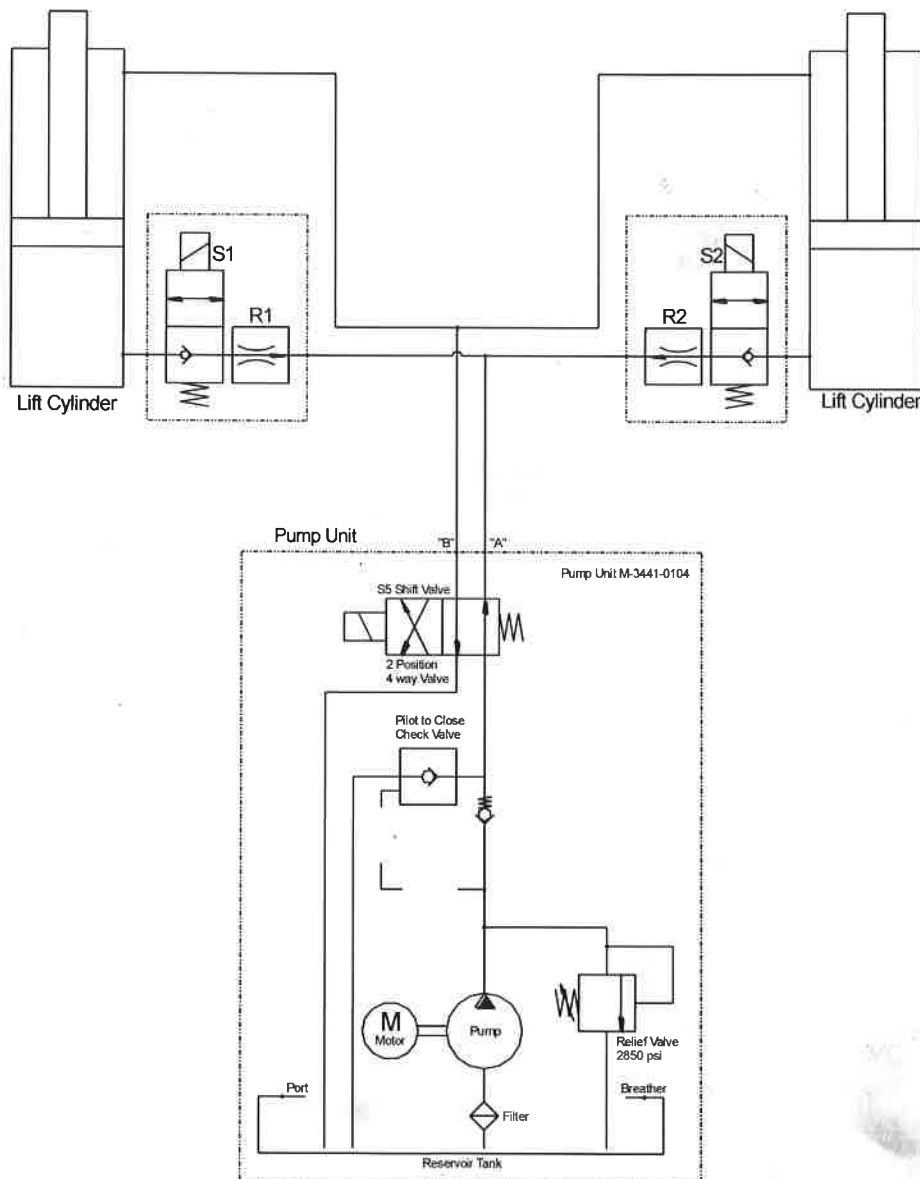

MBB Toggle Control; Full time Power Down ONLY

ILP Power Down
 USA Hydraulic Schematic
 Discontinued on liftgate S/N: PT-10598



14.2 Hydraulic Fluid

All ILP liftgates are equipped with Hydrex MV Arctic 15 hydraulic fluid from factory.

Hydraulic Fluid Installed From Factory	
Property	HYDREX MV ARCTIC 15
<i>Start Up Temperature</i>	<50°C / -58°F
<i>Operating Temperature</i>	-45°C to +23°C / -49°F to 73°F
<i>Pour Point</i>	-57°C / -71°F
<i>Flash Point</i>	128°C / 262°F
<i>Density 15°C (59°F). kg/L</i>	0.834
<i>Viscosity:</i>	
<i>cSt @ 40°C/SUV @ 100°F</i>	13.0 / 69.7
<i>cSt @ 100°C/SUV @ 210°F</i>	4.95 / 42.5
<i>cP @ -50°C (-58°F)</i>	1,310

When changing or adding fluids, it is highly recommended to use Hydrex MV Arctic 15 fluid, however, the alternatives fluid brands listed below can be used.

Alternative Fluids	
Temperature Range	Fluid Brand
30° to 150° F	EXXON UNIVIS J26
	MOBIL DTE 13M
	CHEVRON AW MV32
	ROSEMEAD MV 150 (32)
-50° to 150° F	MOBILE DTE 11
	SHELL AERO FLUID 4/41
	SHELL TELLUS 15
Extreme Cold Temperature	MIL H5606 (Military Spec.)

15 Decal Placement and Inspection



For operator's safety, all decals appearing in "Decal Kit" must be placed visibly on the control side of liftgate to be read by operator. This is typically a combination of decals on the liftgate and truck/trailer body. Make sure to place the maximum capacity decal (D) on driver and curb side of the vehicle.

Important: Never remove or paint over any decal. If any decals below require replacement contact Palfinger Liftgates for replacements.

Decal Kit			
Decal	Qty.	Part No.	Description
A	1	ATG-URGWA	Urgent Warning: Elevating gate instructions
B	1	ATG-ILR-ILFS	Operating Instructions
C	1	ATG-BKR	Circuit Breaker Reset (must be located at the circuit breaker)
D	2	ATG-XXXX	Capacity (check the serial number plate to find out the gates specific capacity).
E	1	ATG-RESET	Circuit Breaker Protection
F	2	ATG-WLH	Warning: liftgate can crush
G	2	ATG-PLAT	Warning: Always stand clear of platform area
H	1	ATG-CAB	Liftgate Shut-Off (Place Decal next to the On-Off Switch in the Cab)
I	1	ATG-UD	Toggle Switch Decal (located on post for Trucks) Or (located on strut brace for flatbeds)
J	1	ATG-WNG	Warning: Use handle to open (must be located underneath handle (main section))

NOTICE

It is the installer's responsibility to determine that the vehicle meets DOT and federal lighting regulations. Keep in mind that there are different requirements depending on the classification of the vehicle. This document is not intended to replace published agency regulations, and it is strongly recommended that the installer references the Code of Federal Regulations (CFR) which can be viewed at <http://www.ecfr.gov>

Decal - A

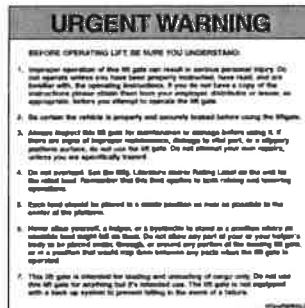

Decal - B

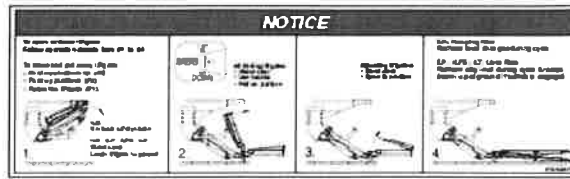

Decal - C

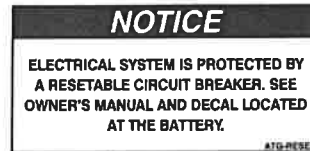
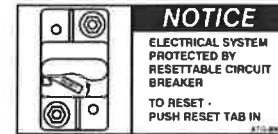

Decal - E



Decal - F



Decal - D



Decal - G

Decal - H

Decal - I

Decal - J

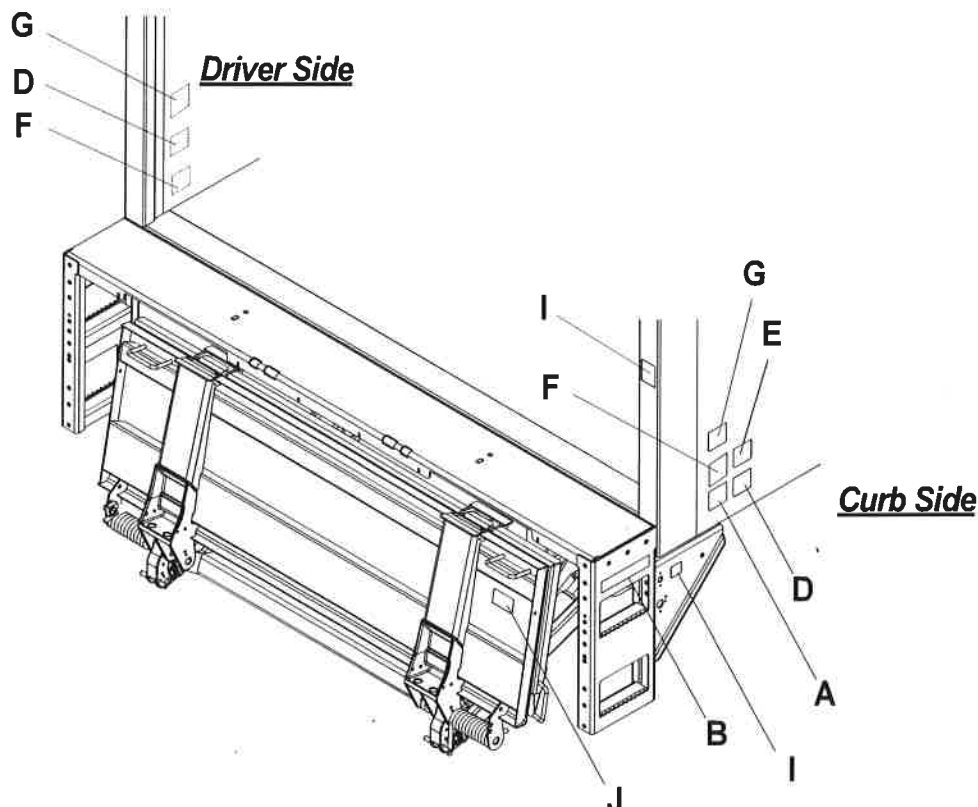

16 Lubrication

1. Lower the platform to the ground.
2. Remove red protector caps from each component. Lubricate, grease, and oil per diagram below.
3. Cycle platform up and down several times. Lubricate and grease all points again.
4. Wipe any excess grease and replace all red protector caps on zerks.

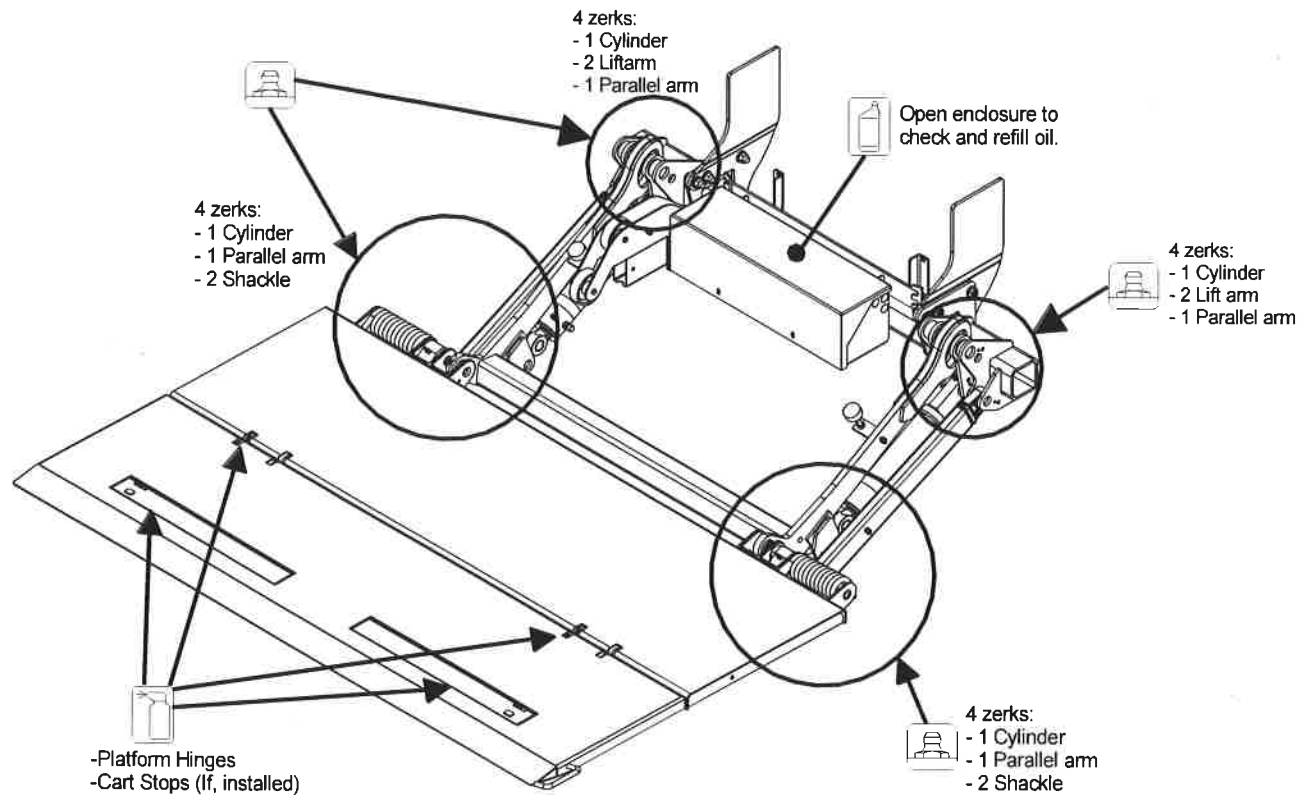

Grease: Location of Grease Zerks (7 on each side, 14 total).



Oil: Oil level in the power pack tank (see marking inside of power pack reservoir).

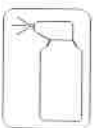

Lubricate: Platform hinges, Slide Rails and optional Cart Stops.

17 Final Inspection Check List

WARNING

Liftgate failure or malfunction could result in property damage, personal injury or death if you fail to check each of the following items listed. **DO NOT USE** the liftgate if any of the following points are **NOT** verified and checked.

Installation is **NOT** complete and all **WARRANTIES** are **VOID** if you have not checked and verified all items listed on this inspection sheet. Inspection sheet is to be filled out at the facility where liftgate was installed and **MUST** be sent to Palfinger Liftgates for warranty activation.

Structural Inspection

- ☐ All welds are 100% complete per this manual.
- ☐ All nuts, bolts, mounting hardware, pins, chain anchors are tight.
- ☐ All mounting dimensions are correct and liftgate is square and parallel per this manual.

Hydraulic Inspection

- ☐ Pump reservoir is filled to 1" from top of reservoir when cylinders are completely compressed (platform is resting on the ground).
- ☐ Hydraulic components and connections do not leak.
(Should be checked after unit is hydraulically locked for five (5) minutes.)
- ☐ All hydraulic lines are secured with cable ties, hoses clamps, or other fasteners. No hoses or components rub on the frame, platform, or any other components while unit is in operation or in storage. No hoses are kinked or bent.

Electrical Inspection

- ☐ Battery cable(s) attached and clamped tight and dielectric grease is used to seal all connections.
- ☐ All electrical lines are secured with cable ties, hoses clamps, or other fasteners and are properly protected and away from sharp edges and moving parts.
- ☐ Circuit Breakers installed and wired per instructions.
- ☐ Measure battery voltages: Flooded Batteries = 12.6V; AGM Batteries = 12.8V
- ☐ Lights wired properly and operate per DOT, State, and Federal requirements.

Operational Inspection

- ☐ All decals are in place and legible per instructions.
- ☐ All pivot points are lubricated per instructions, and serk fittings have been capped.
- ☐ Up stops are in place. Wheel is set for proper opening when lowering.
- ☐ Coil springs have been adjusted at the platform for proper folding and unfolding tension.
- ☐ Snubber pads are adjusted tight against platform.
- ☐ Bolts or welds are removed from both swing arm fixtures (Section 12.3).
- ☐ Platform travels up and down smoothly and freely, without any hesitation, interference, or unusual noises.
- ☐ Platform is flush with the bed extension, tip is pitched 2" above rear bed extension when raised completely.
- ☐ Platform rests on the ground evenly when lowered completely.
- ☐ Platform raises and lowers properly and at correct speed. (2 to 4 inches per second)
- ☐ Gate is painted, body is clean around gate. Chrome cylinder shafts are not painted. Rubber & plastic caps are in place.
- ☐ The liftgate serial number and model number are documented on the inside of the front cover of the Owners Manual (pg. 4), as well as the installation manual in the space provided (pg.4).
- ☐ Owners Manual is in the vehicle's glove box.
- ☐ Supervisor has demonstrated the instructions in the Owners Manual to the customer/driver upon delivery.

Inspection Information (Please Print):

Name: _____ Signature: _____

Completed by: _____

Title: _____ Date: _____

Liftgate Model: _____ Liftgate Serial Number: _____