

In-Vehicle Service Procedures

How to Remove the Air Module

Special Instructions

⚠ WARNING

A sudden release of air pressure can cause personal injury or damage to equipment. To prevent injury or equipment damage, exhaust the Vehicle Air System or shut off the air supply to the Transmission before removing the Air Module.

Note: For air line removal and replacement instructions, refer to the “Air Line and Fitting” portion of In-Vehicle Service Procedures.

Special Tools

- Typical service tools

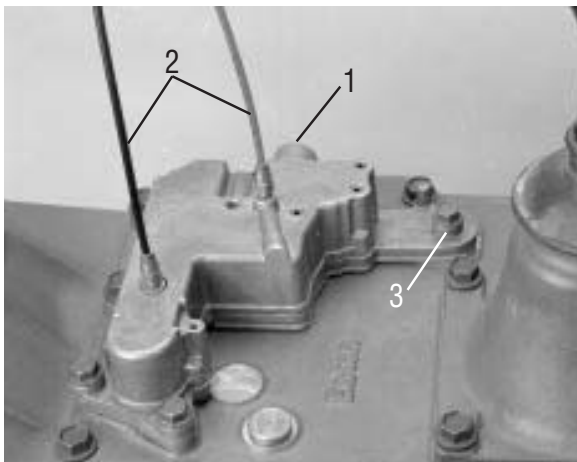
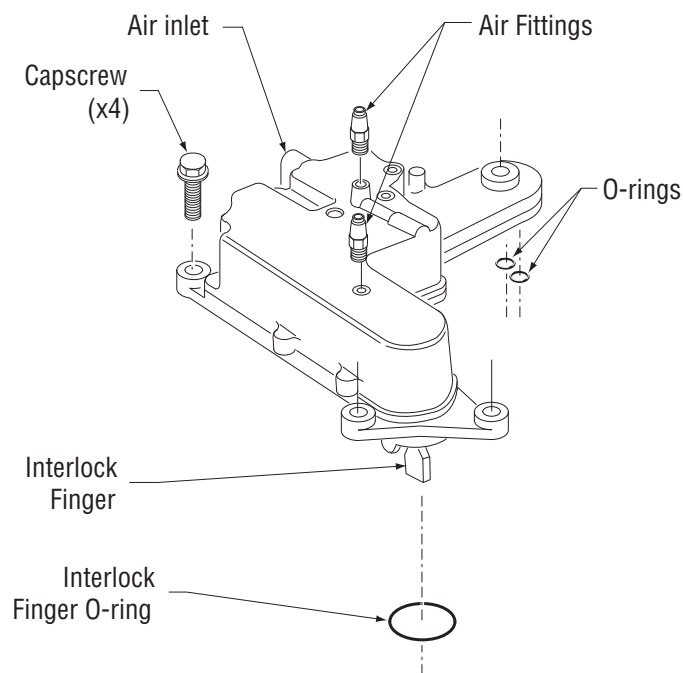

Procedure -

1. Disconnect the supply air line from the Inlet Port of the Air Module.
2. Tag the two air lines connected to the ports on the top of the Air Module with location information, and remove them.
3. From the Air Module, remove the four (4) capscrews, and lift the Module from the Shift Bar Housing.

4. From the Air Module Interlock Finger, remove the O-ring, and inspect it for damage or wear. Replace it if necessary.
5. From the two small recesses in the Shift Bar Housing Top, remove the two (2) O-rings and inspect them for damage or wear. Replace them if necessary.

Note: The O-rings may stick to the bottom of the Air Module.



In-Vehicle Service Procedures

How to Install the Air Module

Special Instructions

None

Special Tools

- Torque Wrench, 25 lb. ft. Capacity

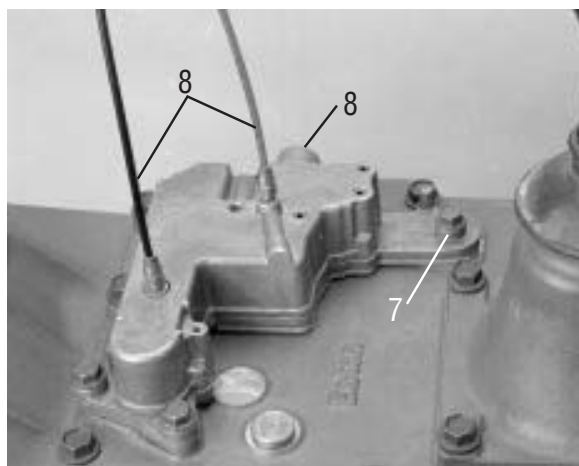
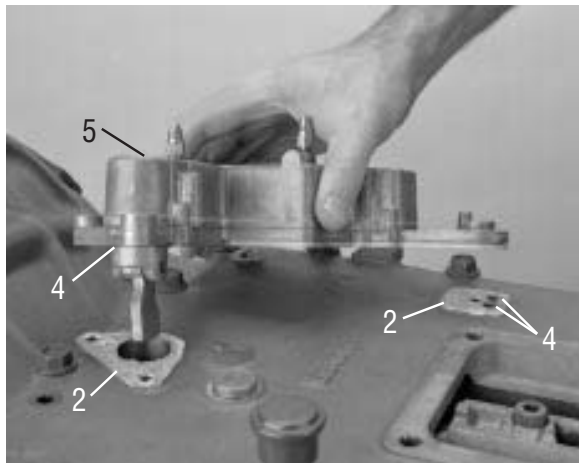

Procedure -

1. Clean all rust, paint, or other debris from the Air Module mounting surfaces of the Shift Bar Housing.
2. To help prevent corrosion between the aluminum Air Module and the cast iron Shift Bar Housing, apply a light film of high temperature grease to the Air Module mounting surfaces of the Shift Bar Housing.
3. Lightly apply Eaton®Fuller® silicone lubricant #71206 or equivalent to all O-rings so a film covers the entire surface of each O-ring.
4. Install the large O-ring on the Air Module Interlock Finger Boss, and position the two (2) small O-rings in the recesses in the Shift Bar Housing.
5. Position the Air Module on the Shift Bar Housing.
6. Apply Eaton®Fuller® thread sealant #71205 or equivalent to the four (4) retaining cap screws.
7. Install the four (4) retaining cap screws, and tighten them to 20–23 lb. ft. (27–31 N•m) of torque.
8. Reconnect the air lines to the inlet port and the other ports on the top of the Air Module.
9. Return air to the system, and check for leaks.