

In-Vehicle Service Procedures

How to Remove the Gear Shift Lever/Remote Shift Control

Special Instructions

The air lines must be disconnected from the Transmission or from the Roadranger Valve.

Different Detent Springs are available to increase or decrease shifting effort. Note and record specific locations for specific springs. In some cases, a stiffer spring is installed in the top rail position.

Remote Control Housings are removed the same way as Gear Shift Levers.

Procedure -

1. From the Gear Shift Lever Base/Shift Control Housing, remove the four (4) Retaining Capscrews.

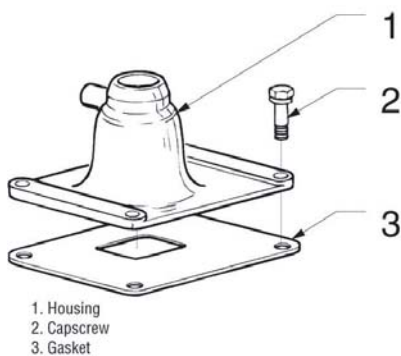

2. To break the gasket seal, lightly jar the Gear Shift/Shift Control Housing.

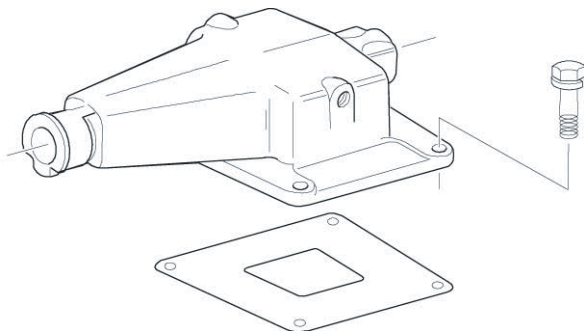

3. Remove the Gear Shift Lever Housing.

⚠ CAUTION

Make sure the Detent Springs do not fall into the Transmission.

4. Remove Detent Springs as needed.
5. Remove the gasket and clean the area the replacement gasket will contact.



How to Install the Gear Shift Lever/Remote Shift Control

Special Instructions

Remote Control Housings are installed the same way as Gear Shift Levers.

For standard and forward Shift Bar Housings, make sure the Detent Springs and Balls are in the Shift Bar Housing top bores.

Make sure the Shift Block and Yoke notches are aligned in the neutral position.

Procedure -

1. Thoroughly clean mounting surface.
2. Position a new gear Shift Lever/Shift Control Housing Gasket on the Gear Shift Lever mounting surface.
3. Install the Detent Springs.
4. Install the Shift Lever/Shift Control Housing. Make sure the tip (finger) of the Gear Shift Lever fits into the slots in the Shift Block.
5. Apply Eaton/Fuller Sealant #71205 or equivalent to the retaining capscrews.
6. Install the retaining capscrews, tighten to 35–45 lbs.ft. of torque.

Note: Make sure the capscrews are properly torqued.

Note: Make sure you can shift the Transmission.

